



# OSP ASCEND II™ Sit-Stand • Height Adjustable • Active Working

OSP ASCEND II™ features top quality electric height adjustable workstations, coordinating with OSP systems, casegoods and table offering. Standard features include push-button height adjustment, 3-position programmable memory handset and anti-collision with sensitivity adjustment. Width-adjustable bases accommodate 48"-72" wide x 24" deep tops. Optional 30" deep feet. Simple assembly. Meets UL962 and ANSI/BIFMA.





**A336078BS**  
Black Base  
Slate Grey Top

## Deluxe C-Leg Bases

Fast • Quiet • Width Adjustable

Base (without top)	Height Range	Load Capacity	High/Low Position
A2EB322	25.25"	220 lbs.	50" / 24.75"
A2EB333	25.5"	300 lbs.	50.25" / 24.75"
A2EB222	17.25"	175 lbs.	44.75" / 27.5"

47" Fixed Width Base (see page 82):

A2EB212	18.75"	160 lbs.	47.25" / 28.5"
---------	--------	----------	----------------

Also available, PWS tops on page 28.

⚙️ Bases are TAA Compliant



**AM2030B** Standing Mat  
See page 119

## Tops

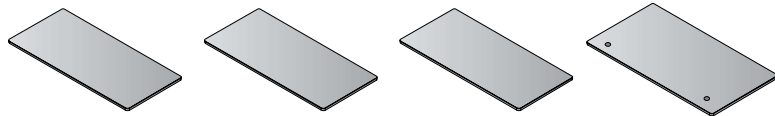

**842T26-X**  
Table Top 72"x24"  
CU: 1.9 WT: 44  
List: **\$440**

**842T25-x**  
Table Top 60"x24"  
CU:1.6 WT:36  
List: **\$390**

**842T24-x**  
Table Top 48"x24"  
CU:1.3 WT:28  
List: **\$330**

**842T3060-x**  
Table Top 60"x30"  
CU: 2.5 WT: 50.7  
List: **\$460**

## Top Colors



## Bases

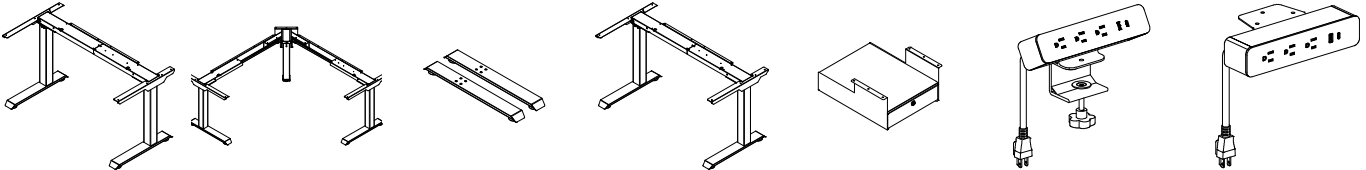

**A2EB322-xx**  
3-Stage/2-Leg  
CU:2.8 WT:64  
List: **\$1,550**

**A2EB333-xx**  
3-Stage/3-Leg  
CU:2.9 WT:94  
List: **\$2,500**

**A2FEET30-x**  
Feet for 30"D Tops  
(set of 2)  
CU:0.27 WT:12  
List: **\$175**

**A2EB222-x**  
2-Stage/2-Leg  
CU:2.8 WT:59  
List: **\$1,500**

**A2PS-x**  
Personal Storage  
15.5"W x 18"D x 7.5"H  
CU:1.49 WT:34  
List: **\$275**

**PM5311B Black**  
**PM5311W White**  
Power Charger  
Clamp-Mount  
Includes: USB Type-C,  
USB Type-A and  
(3) A/C plugs  
Fits ½" – 1½" surfaces  
CU:0.22 WT:3  
List: **\$290**

**PM8311B Black**  
**PM8311W White**  
Power Charger  
Undersurface Mount  
Includes: USB Type-C,  
USB Type-A and  
(3) A/C plugs  
CU:0.22 WT:3  
List: **\$290**

## Base Colors

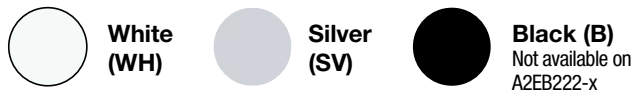

## Modesty Panels

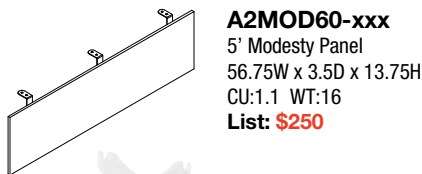

**A2MOD60-xxx**  
5' Modesty Panel  
56.75W x 3.5D x 13.75H  
CU:1.1 WT:16  
List: **\$250**

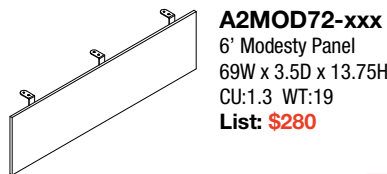

**A2MOD72-xxx**  
6' Modesty Panel  
69W x 3.5D x 13.75H  
CU:1.3 WT:19  
List: **\$280**

## Modesty Colors

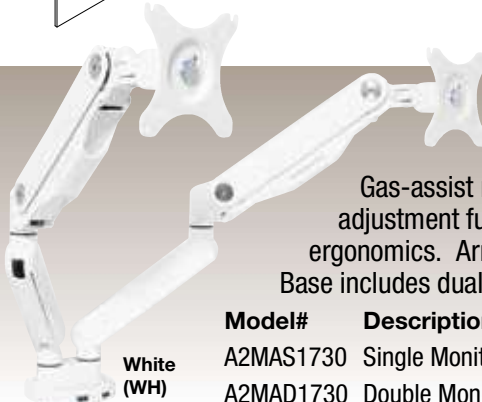

## OSP ASCEND II™ Monitor Arms

Gas-assist monitor arms with 3-point adjustment further individualize workplace ergonomics. Arms support 17"-30" monitors. Base includes dual USB 3.0 ports within easy reach.

Model#	Description	List
A2MAS1730	Single Monitor Arm with Dual USB 3.0 Ports	<b>\$275</b>
A2MAD1730	Double Monitor Arm with Dual USB 3.0 Ports	<b>\$525</b>





**OYF222-WT**  
Dual-Motor / 2-Stage Height Adjustable Base,  
White **\$1,000**  
Shown with 60"W x 30"D Natty Ash Top **\$525**  
More sizes & colors available; see page 28

**On Your Feet!**

A new high-value, dual-motor/2-stage sit/stand base pairs with the PWS Series tops (see page 28) for extensive size options in our best-selling laminate colors.

**Base Colors**

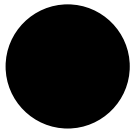

**BK**  
Black

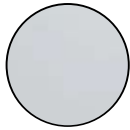

**SL**  
Silver

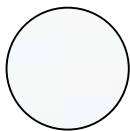

**WT**  
White

**FEATURES**

- Multiple memory presets
- Width-adjustable to support 48" -72" wide tops
- Supports 24"-30" deep tops
- Weight capacity 220 lbs. (including top)
- Adjusts 27.5" to 46.75" high
- Moves 25 mm/s
- Less than 50 dB
- 200 lbs. weight capacity (evenly distributed, top included)
- White, silver & black finishes

**PWS Series**

See page 28 for top sizes/prices



**URB**  
Urban Walnut

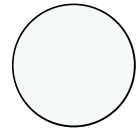

**WHT**  
White



**SGW**  
Slate Grey



**NAS**  
Natty Ash



**ESP**  
Espresso  
NJ Only



**PCW**  
Park City  
NJ Only



**OYF222-WT** | **PWS6030-SGW**  
Base, White | Top, Slate Grey (see page 28)



Adjusts 27.5" to 46.75"H  
Width-adjustable to support 48"-72"W tops

## Single-Motor Height Adjustable Base



**A2EB212-x**

**Fixed-Width  
47"W x 23.5"D**

**Height Adjustment Range: 19"  
Hi / Low Positions (Base):  
47" / 28"  
With 842T24 Top: 48" / 29"  
Load Capacity (Base): 160 lbs.**



### Additional Features:

Memory Control • 4 Programmable Presets • Anti-Collision  
UL Certified Components • Meets BIFMA Testing Standards

### TOP

### TOP COLORS

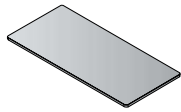

**842T24-x**  
Table Top 48"x24"  
CU:1.3 WT:28  
List: **\$330**



**Cherry  
(C)**



**Espresso  
(E)**



**Grey  
(G)**



**Mahogany  
(M)**



**Maple  
(N)**

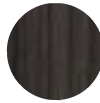

**Slate Grey  
(S)**



**Urban Walnut  
(U)**

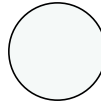

**White  
(W)**

### BASE

### BASE COLORS

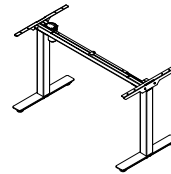

**A2EB212-x**  
48" Wide  
Single-Motor Base  
CU:6.2 WT:71  
List: **\$1,150**



**Grey (GR)**



**Black (B)**

## Typicals

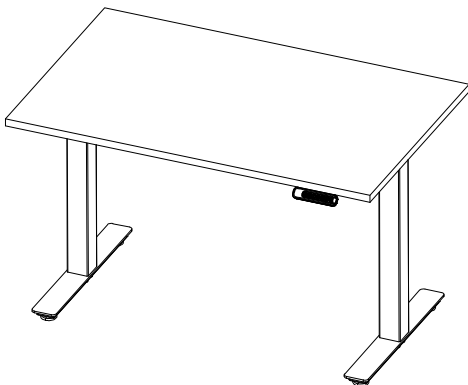

**Single Motor  
48" x 24" x 48-29"H**  
Electric Height Adjustable Table  
CU: 7.5 WT.: 99  
List: **\$1,480**

Typical#	List	Description	TOP	List	BASE	List
A212448BC	\$1480	Cherry Top/Black Base	842T24-C	\$330	A2EB212-B	\$1150
A212448BE	\$1480	Espresso Top/Black Base	842T24-E	\$330	A2EB212-B	\$1150
A212448BG	\$1480	Grey Top/Black Base	842T24-G	\$330	A2EB212-B	\$1150
A212448BM	\$1480	Mahogany Top/Black Base	842T24-M	\$330	A2EB212-B	\$1150
A212448BN	\$1480	Natty Ash Top/Black Base	842T24-N	\$330	A2EB212-B	\$1150
A212448BS	\$1480	Slate Grey Top/Black Base	842T24-S	\$330	A2EB212-B	\$1150
A212448BU	\$1480	Urban Walnut Top/Black Base	842T24-U	\$330	A2EB212-B	\$1150
A212448BW	\$1480	White Top/Black Base	842T24-W	\$330	A2EB212-B	\$1150
A212448GRC	\$1480	Cherry Top/Grey Base	842T24-C	\$330	A2EB212-GR	\$1150
A212448GRE	\$1480	Espresso Top/Grey Base	842T24-E	\$330	A2EB212-GR	\$1150
A212448GRG	\$1480	Grey Top/Grey Base	842T24-G	\$330	A2EB212-GR	\$1150
A212448GRM	\$1480	Mahogany Top/Grey Base	842T24-M	\$330	A2EB212-GR	\$1150
A212448GRN	\$1480	Natty Ash Top/Grey Base	842T24-N	\$330	A2EB212-GR	\$1150
A212448GRS	\$1480	Slate Grey Top/Grey Base	842T24-S	\$330	A2EB212-GR	\$1150
A212448GRU	\$1480	Urban Walnut Top/Grey Base	842T24-U	\$330	A2EB212-GR	\$1150
A212448GRW	\$1480	White Top/Grey Base	842T24-W	\$330	A2EB212-GR	\$1150

# pro·line II Mesh Folding Chair, Power Station and Height Adjustable Tables



**81308 Deluxe ProGrid® Mesh Seat and Back Folding Chair with Black Finish Frame (2-Pack)**

**NJ** Overall Size: 20.25W x 22D x 34.25H  
 Seat: 17.5W x 18.25D Back: 20.25W x 11H Seat Range: 17.75 Fixed  
 Arms to Floor: N/A Carton Wt: 32 UPS: Yes COM: N/A  
 Carton: 43L x 21W x 7H Cube: 3.65 Options: N/A  
 Features: N/A Control: N/A  
 Notes: Sold in 2-Pack Only Gangable and Stackable. Patent# US D647,718 S

Fabric	List Price
ProGrid® Seat and Back	460.00 (2-Pack)
<b>400 lbs.</b>	

## Power Station



**NJ PAS311-36 Power Anywhere Station, 3 A/C Outlets, 1 USB-C, 1 USB-A, 7.5 ft. Cord**

Overall Size: 12.75W x 12.5D x 35.75H  
 Column Size: 3.5W x 3.5D  
 Carton Wt: 16 UPS: Yes COM: N/A  
 Carton: 39L x 15W x 15H Cube: 5.07 Options: N/A  
 Features: UL962A, CUL962A  
 Notes: 120V A/C, 60Hz (12V Max)

Finish	List Price
BK Black SV Silver WH White	350.00

## Height Adjustable Tables



**NJ STH4848 Stealth 48" Corner Sit/Stand Electric Desk with 3-Programmable Height Memory, 2-USB Receptacles, 2 Cable Management Port**

Overall Size: 47.25W x 25.5D x 29.5 - 47.25H  
 Height Minimum: 29.5 Height Maximum: 47.25  
 Carton Wt: 89 ISTA: 6 UPS: Yes  
 Carton: 42L x 30W x 7H Cube: 5.1  
 Desktop Weight Capacity: 110 lbs.  
 Notes: Wireless Charging, Center Drawer, Accessories/Headphone Hook, Cup Holder, Storage Tray, Easy Assembly

**adjustable height**

Finish	List Price
-WH White	950.00



**NJ PMO4825WCF Primo Sit-to-Stand Electric Height Adjustable Desk with Electric One-Touch Controls, 4-Programmable Height Memory, 2-USB Ports**

Overall Size: 47.25W x 25.5D x 28.5 - 47H  
 Height Minimum: 28.5 Height Maximum: 47  
 Carton Wt: 65 ISTA: 6 UPS: Yes  
 Carton: 52L x 30W x 7H Cube: 6.31  
 Desktop Weight Capacity: 100 lbs.  
 Notes: Laminate Top, Cup Holder, 2 Hooks, Simple Assembly,

**adjustable height**

**NEW**

Finish	List Price
White Carbon Fiber	625.00



**NJ PMO4823/PMO4823B Primo 48" Sit/Stand Electric Height Adjustable Desk with Electric One-Touch Controls, and Programmable Height Memory**

Overall Size: 47.25W x 23.5D x 29.25 - 46.75H  
 Height Minimum: 29.25 Height Maximum: 46.75  
 Carton Wt: 55 ISTA: 6 UPS: Yes  
 Carton: 27L x 13W x 6H Cube: 1.21  
 Desktop Weight Capacity: 150 lbs.  
 Notes: Laminate Top, Hook for Headphones, Simple Assembly

**adjustable height**

**NEW**

Finish	List Price
-WH White	450.00
<b>PMO4823B-LG</b> Black Base/ Light Grey Top	



**NJ PMO6024/PMO6024B Primo 60" Sit/Stand Electric Height Adjustable Desk with Electric One-Touch Controls, and Programmable Height Memory**

Overall Size: 59W x 23.75D x 29.5 - 47H  
 Height Minimum: 29.25 Height Maximum: 47  
 Carton Wt: 75 ISTA: 6 UPS: Yes  
 Carton: 62L x 27W x 6H Cube: 5.81  
 Desktop Weight Capacity: 140 lbs.  
 Notes: Laminate Top, Hook for Headphones, Simple Assembly

**adjustable height**

**NEW**

Finish	List Price
-WH White	595.00
<b>PMO6024B-LG</b> Black Base/ Light Grey Top	



Shown with optional A2MOD72 modesty panel; see page 76



Urban Walnut (U)



Slate Grey (S)



Cherry (C)



Espresso (E)

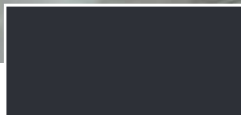

Black (3)



Grey (G)



Mahogany (M)



Titanium (7)



Natty Ash (N)



White (W)



White (1)

## TOP COLORS

## BASE COLORS

⚙️ Bases are TAA Compliant



13" Height Adjustment

# PHAT Pneumatic Height Adjustable Tables

Sit & stand throughout your workday to keep your body and mind in motion. New PHAT Table (Pneumatic Height Adjustable Tables) worksurfaces adjust from 30.25" to 43.25", a 13" range, with a single lever. Included black locking casters provide more on-the-go capability. Heavyweight bases include dual-pneumatic power and driveshaft-synchronized operation. Fully enclosed center channel conceals components. Tops and Bases sold, packed and shipped individually.



White Top/White Base

### 48" x 24" Pneumatic Height Adjustable Table with Black Locking Casters

CU: 3.1 (2 cartons) WT.: 95

**List: \$1,330**

⚙️ Bases are TAA Compliant

Typical#	Description	TOP	List	BASE	List
PHAT2448C1	Cherry Top/White Base	842T24-C	\$330	HB6024-1	\$1000
PHAT2448E1	Espresso Top/White Base	842T24-E	\$330	HB6024-1	\$1000
PHAT2448G1	Grey Top/White Base	842T24-G	\$330	HB6024-1	\$1000
PHAT2448M1	Mahogany Top/White Base	842T24-M	\$330	HB6024-1	\$1000
PHAT2448N1	Natty Ash Top/White Base	842T24-N	\$330	HB6024-1	\$1000
PHAT2448S1	Slate Grey Top/White Base	842T24-S	\$330	HB6024-1	\$1000
PHAT2448U1	Urban Walnut Top/White Base	842T24-U	\$330	HB6024-1	\$1000
PHAT2448W1	White Top/White Base	842T24-W	\$330	HB6024-1	\$1000
PHAT2448C3	Cherry Top/Black Base	842T24-C	\$330	HB6024-3	\$1000
PHAT2448E3	Espresso Top/Black Base	842T24-E	\$330	HB6024-3	\$1000
PHAT2448G3	Grey Top/Black Base	842T24-G	\$330	HB6024-3	\$1000
PHAT2448M3	Mahogany Top/Black Base	842T24-M	\$330	HB6024-3	\$1000
PHAT2448N3	Natty Ash Top/Black Base	842T24-N	\$330	HB6024-3	\$1000
PHAT2448S3	Slate Grey Top/Black Base	842T24-S	\$330	HB6024-3	\$1000
PHAT2448U3	Urban Walnut Top/Black Base	842T24-U	\$330	HB6024-3	\$1000
PHAT2448W3	White Top/Black Base	842T24-W	\$330	HB6024-3	\$1000
PHAT2448C7	Cherry Top/Titanium Base	842T24-C	\$330	HB6024-7	\$1000
PHAT2448E7	Espresso Top/Titanium Base	842T24-E	\$330	HB6024-7	\$1000
PHAT2448G7	Grey Top/Titanium Base	842T24-G	\$330	HB6024-7	\$1000
PHAT2448M7	Mahogany Top/Titanium Base	842T24-M	\$330	HB6024-7	\$1000
PHAT2448N7	Natty Ash Top/Titanium Base	842T24-N	\$330	HB6024-7	\$1000
PHAT2448S7	Slate Grey Top/Titanium Base	842T24-S	\$330	HB6024-7	\$1000
PHAT2448U7	Urban Walnut Top/Titanium Base	842T24-U	\$330	HB6024-7	\$1000
PHAT2448W7	White Top/Titanium Base	842T24-W	\$330	HB6024-7	\$1000

CU: 1.3 WT: 30 CU: 1.8 WT: 65



Cherry Top/Titanium Base

### 60" x 24" Pneumatic Height Adjustable Table with Black Locking Casters

CU: 3.8 (2 cartons) WT.: 107

**List: \$1,440**

⚙️ Bases are TAA Compliant

PHAT2460C1	Cherry Top/White Base	842T25-C	\$390	HB6025-1	\$1050
PHAT2460E1	Espresso Top/White Base	842T25-E	\$390	HB6025-1	\$1050
PHAT2460G1	Grey Top/White Base	842T25-G	\$390	HB6025-1	\$1050
PHAT2460M1	Mahogany Top/White Base	842T25-M	\$390	HB6025-1	\$1050
PHAT2460N1	Natty Ash Top/White Base	842T25-N	\$390	HB6025-1	\$1050
PHAT2460S1	Slate Grey Top/White Base	842T25-S	\$390	HB6025-1	\$1050
PHAT2460U1	Urban Walnut Top/White Base	842T25-U	\$390	HB6025-1	\$1050
PHAT2460W1	White Top/White Base	842T25-W	\$390	HB6025-1	\$1050
PHAT2460C3	Cherry Top/Black Base	842T25-C	\$390	HB6025-3	\$1050
PHAT2460E3	Espresso Top/Black Base	842T25-E	\$390	HB6025-3	\$1050
PHAT2460G3	Grey Top/Black Base	842T25-G	\$390	HB6025-3	\$1050
PHAT2460M3	Mahogany Top/Black Base	842T25-M	\$390	HB6025-3	\$1050
PHAT2460N3	Natty Ash Top/Black Base	842T25-N	\$390	HB6025-3	\$1050
PHAT2460S3	Slate Grey Top/Black Base	842T25-S	\$390	HB6025-3	\$1050
PHAT2460U3	Urban Walnut Top/Black Base	842T25-U	\$390	HB6025-3	\$1050
PHAT2460W3	White Top/Black Base	842T25-W	\$390	HB6025-3	\$1050
PHAT2460C7	Cherry Top/Titanium Base	842T25-C	\$390	HB6025-7	\$1050
PHAT2460E7	Espresso Top/Titanium Base	842T25-E	\$390	HB6025-7	\$1050
PHAT2460G7	Grey Top/Titanium Base	842T25-G	\$390	HB6025-7	\$1050
PHAT2460M7	Mahogany Top/Titanium Base	842T25-M	\$390	HB6025-7	\$1050
PHAT2460N7	Natty Ash Top/Titanium Base	842T25-N	\$390	HB6025-7	\$1050
PHAT2460S7	Slate Grey Top/Titanium Base	842T25-S	\$390	HB6025-7	\$1050
PHAT2460U7	Urban Walnut Top/Titanium Base	842T25-U	\$390	HB6025-7	\$1050
PHAT2460W7	White Top/Titanium Base	842T25-W	\$390	HB6025-7	\$1050

CU: 1.6 WT: 37 CU: 2.2 WT: 70

# PHAT Tables: Pneumatic Height Adjustable Tables



Natty Ash Top/Black Base

Typical#	Description	TOP	List	BASE	List
PHAT2472C1	\$1540	Cherry Top/White Base	842T26-C	\$440	HB6026-1 \$1100
PHAT2472E1	\$1540	Espresso Top/White Base	842T26-E	\$440	HB6026-1 \$1100
PHAT2472G1	\$1540	Grey Top/White Base	842T26-G	\$440	HB6026-1 \$1100
PHAT2472M1	\$1540	Mahogany Top/White Base	842T26-M	\$440	HB6026-1 \$1100
PHAT2472N1	\$1540	Natty Ash Top/White Base	842T26-N	\$440	HB6026-1 \$1100
PHAT2472S1	\$1540	Slate Grey Top/White Base	842T26-S	\$440	HB6026-1 \$1100
PHAT2472U1	\$1540	Urban Walnut Top/White Base	842T26-U	\$440	HB6026-1 \$1100
PHAT2472W1	\$1540	White Top/White Base	842T26-W	\$440	HB6026-1 \$1100
PHAT2472C3	\$1540	Cherry Top/Black Base	842T26-C	\$440	HB6026-3 \$1100
PHAT2472E3	\$1540	Espresso Top/Black Base	842T26-E	\$440	HB6026-3 \$1100
PHAT2472G3	\$1540	Grey Top/Black Base	842T26-G	\$440	HB6026-3 \$1100
PHAT2472M3	\$1540	Mahogany Top/Black Base	842T26-M	\$440	HB6026-3 \$1100
PHAT2472N3	\$1540	Natty Ash Top/Black Base	842T26-N	\$440	HB6026-3 \$1100
PHAT2472S3	\$1540	Slate Grey Top/Black Base	842T26-S	\$440	HB6026-3 \$1100
PHAT2472U3	\$1540	Urban Walnut Top/Black Base	842T26-U	\$440	HB6026-3 \$1100
PHAT2472W3	\$1540	White Top/Black Base	842T26-W	\$440	HB6026-3 \$1100
PHAT2472C7	\$1540	Cherry Top/Titanium Base	842T26-C	\$440	HB6026-7 \$1100
PHAT2472E7	\$1540	Espresso Top/Titanium Base	842T26-E	\$440	HB6026-7 \$1100
PHAT2472G7	\$1540	Grey Top/Titanium Base	842T26-G	\$440	HB6026-7 \$1100
PHAT2472M7	\$1540	Mahogany Top/Titanium Base	842T26-M	\$440	HB6026-7 \$1100
PHAT2472N7	\$1540	Natty Ash Top/Titanium Base	842T26-N	\$440	HB6026-7 \$1100
PHAT2472S7	\$1540	Slate Grey Top/Titanium Base	842T26-S	\$440	HB6026-7 \$1100
PHAT2472U7	\$1540	Urban Walnut Top/Titanium Base	842T26-U	\$440	HB6026-7 \$1100
PHAT2472W7	\$1540	White Top/Titanium Base	842T26-W	\$440	HB6026-7 \$1100

**72" x 24" Pneumatic Height Adjustable Table with Black Locking Casters**

CU: 4.6 (2 cartons) WT.: 118

List: \$1,540

⚙ Bases are TAA Compliant

CU: 1.9 WT: 44 CU: 2.7 WT: 74

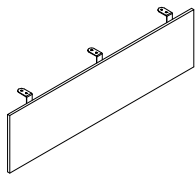

**A2MOD60-xxx**  
5' Modesty Panel  
56.75W x 3.5D x 13.75H  
CU:1.1 WT:16  
List: \$250

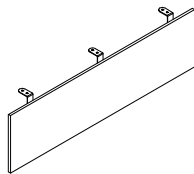

**A2MOD72-xxx**  
6' Modesty Panel  
69W x 3.5D x 13.75H  
CU:1.3 WT:19  
List: \$280



Espresso (ESP)



Slate Grey (SGW)



Urban Walnut (URB)



White (WHT)



**HB4GLIDE**  
Floor Glides (set of 4)  
Carton Wt: 1 Cube: 0.195  
Designed For:  
PHAT & HAT Tables  
List Price: \$35 (set of 4)



**PM5311B Black**  
**PM5311W White**  
Power Charger  
Clamp-Mount  
Includes: USB Type-C,  
USB Type-A & (3) A/C plugs  
Fits 1/2" - 1 1/2" surfaces  
CU:0.22 WT:3  
List Price: \$290



**PM8311B Black**  
**PM8311W White**  
Power Charger  
Undersurface Mount  
Includes: USB Type-C,  
USB Type-A & (3) A/C plugs  
CU:0.22 WT:3  
List Price: \$290

## OSP AXIOS™ Monitor Arms

Weight Capacity 4-20 lbs. | Tilt +85°, -30° Swivel +/-90°  
Rotate 360° | ANSI BIFMA Tested | VESA monitor mount  
75x75 & 100x100 | Clamp or grommet mount to desk/table



Charcoal

**SPX2720DMA**  
Double Monitor Arm  
17-27" Monitors  
List: \$300

**SPX3020SMA**  
Single Monitor Arm  
17-30" Monitors  
List: \$175

